

StoGuard[®] Tape

80269 StoGuard Tape 6"
80271 StoGuard Tape 9"

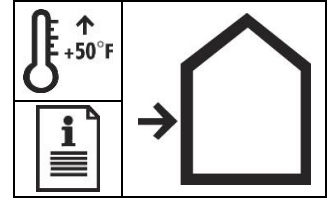

Technical Data

DESCRIPTION	WIDTH OF ROLL	LENGTH OF ROLL	THICKNESS
StoGuard Tape 6"	152 mm (6")	15.2 m (50')	40 mils
StoGuard Tape 9"	229 mm (9")	15.2 m (50')	40 mils

Features Benefits

Features	Benefits
1 Waterproof	Virtually impermeable to the passage of liquid water
2 Flexible	Accommodates minor settlement and shrinkage movement
3 Crack Bridging	Seals minor cracks in concrete and CMU construction
4 Coating Compatible	Most coatings adhere to fabric facing

StoGuard Tape is a self-adhering waterproof air barrier material composed of spun bond polyester fabric laminated to rubberized asphalt adhesive.

The polyester fabric strengthens the material while providing a surface to which most coatings will bond. The rubberized asphalt adhesive sticks to most clean, dry, smooth surfaces, including prepared, primed concrete and concrete masonry, plywood and OSB sheathings, Glass mat faced gypsum sheathings, cement board, asphalt saturated felt and most house wraps.

- *StoGuard Tape is designed to be used on above grade vertical wall surfaces as:*
- *Rough opening protection at windows, doors, and other openings in wood or metal frame construction*
- *Waterproofing and air barrier for minor cracks in concrete and CMU wall construction*
- *Secondary seal behind sealant joints*
- *Air barrier connection material at dissimilar materials*
- *Backer seal for brick anchors*

Packaging

80269 StoGuard Tape 6":
6 rolls per box
80271 StoGuard Tape 9":
4 rolls per box

Storage

Store in dry area. Protect from excess heat, cold and direct sunlight.

StoGuard® Tape

Surface Preparation

Surfaces must be clean, dry, smooth, structurally sound, and free of frost, grease, dust, dirt, oil, efflorescence, and any other surface contamination. CMU surfaces must have joints struck flush with masonry units.

Application

Store material inside at room (21°C [70°F]) temperature. If material is cold, warm it with an electric heat gun. Apply only when ambient and surface temperatures are 10°C (50°F) or above. Apply only to dry surfaces:

1. Pre-cut pieces to required length and pre-fit for precision and productivity.
2. Prime surfaces, including tape to tape overlaps. Refer to StoGuard Primer application instructions or 3M Super 77 spray adhesive may be used.
3. Remove release paper on back of tape.
4. Press tape in place by hand.
5. Overlap minimum 76 mm (3 inches) onto adjacent surfaces and at tape to tape overlaps.
6. Apply firm uniform pressure with a pvc or hard rubber roller.
7. Apply a cap bead of StoGuard RapidSeal along ends and edges.
8. Protect with permanent wall covering within 30 days.

Priming is required. Always apply a test area first to be sure of desired results and to verify adhesion under actual condition of use.

Where necessary level or smooth CMU surfaces with appropriate Sto leveling material.

Refer to Sto Details for specific applications.

IMPORTANT: Counter flash / shingle lap horizontal edge seams with one of the following methods (refer to Figure below):

- StoGuard Fabric embedded in StoGuard coating
- StoGuard Mesh and Sto Gold Fill top coated with StoGuard coating
- StoGuard RapidSeal tooled along edge seam and immediately above and below
- Metal flashing (in turn shingle lapped with StoGuard Fabric or StoGuard Mesh as noted above)

Seal remaining edges and ends of tape with a cap bead of StoGuard RapidSeal.

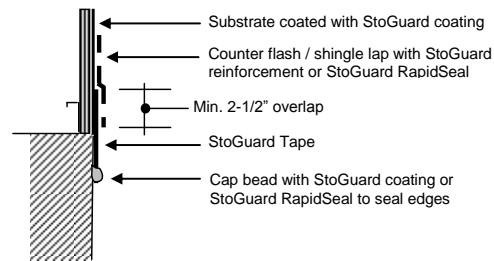

Health And Safety

Health Precautions

Contains asphalt. As with any chemical construction product, exercise care when handling.

Safety Precautions

Safety goggles and protective gloves are recommended.

First Aid

SKIN CONTACT: Wash thoroughly with soap and water.

EYE CONTACT: Flush immediately with water for 10-15 minutes and contact a physician.

RESPIRATORY PROBLEMS: Remove affected person to fresh air immediately and contact a physician.

HYGIENE: Wash hands immediately after use. Wash clothing before re-use.

Disposal

Dispose of in accordance with local, state or federal regulations.

Warning

KEEP OUT OF THE REACH OF CHILDREN. NOT FOR INTERNAL CONSUMPTION. FOR INDUSTRIAL USE ONLY. Consult the Safety Data Sheet for further health and safety information.

Safety Data Sheet (SDS) is available at www.stocorp.com.

LIMITED WARRANTY

This product is subject to a written limited warranty which can be obtained free of charge from Sto Corp.

Refer to *Sto Specifications for more complete information on proper use and handling of this product.*

Limitations

- Not recommended for application during cold (<10°C [50°F]) weather conditions
- Not intended for prolonged (more than 30 days) UV exposure
- Not intended for use below grade or on surfaces subject to continuous or intermittent water immersion
- Not intended for use as an air or water seal at sheathing joints
- Not intended to bridge moving or working joints in construction
- Not compatible with uncured sealants or materials containing plasticizers
- Horizontal edge seams must be counter flashed (refer to diagram). Other edges must be cap sealed.
- CMU surfaces must have joints struck flush with the surface (smooth)

Sto Canada Ltd.
1821 Albion Road
Unit 1 – 2
Etobicoke, Ontario M9W 5W8

S155-80269 - 80271
Revision Number: A2.0
Date: 09/2018

Tel: (416) 855-0460
Toll Free: 1-800-221-2397
Fax: 404 346-3119

www.stocanada.com

Attention

This product is intended for use by qualified professional contractors, not consumers, as a component of a larger construction assembly as specified by a qualified design professional, general contractor or builder. It should be installed in accordance with those specifications and Sto's instructions. Sto Corp. disclaims all, and assumes no, liability for on-site inspections, for its products applied improperly, or by unqualified persons or entities, or as part of an improperly designed or constructed building, for the nonperformance of adjacent building components or assemblies, or for other construction activities beyond Sto's control. Improper use of this product or use as part of an improperly designed or constructed larger assembly or building may result in serious damage to this product, and to the structure of the building or its components. **STO CORP. DISCLAIMS ALL WARRANTIES EXPRESSED OR IMPLIED EXCEPT FOR EXPLICIT LIMITED WRITTEN WARRANTIES ISSUED TO AND ACCEPTED BY BUILDING OWNERS IN ACCORDANCE WITH STO'S WARRANTY PROGRAMS WHICH ARE SUBJECT TO CHANGE FROM TIME TO TIME.** For the fullest, most current information on proper application, clean-up, mixing and other specifications and warranties, cautions and disclaimers, please refer to the **Sto Canada Ltd.** website, www.stocanada.com.